



FUTURE PLAST

MEMBER OF ENPI GROUP



FUTURE PLUS

MEMBER OF ENPI GROUP

PREFORMS & CLOSURES

FUTURE PLAST

+971 2 550 99 98 | P.O. BOX 133448
57 AL DHAKA ST. ICAD-1 ABU DHABI, UNITED ARAB EMIRATES

FUTURE PLUS

+966 11 265 1985 | P.O. BOX 355813
2ND INDUSTRIAL AREA, 3RD PHASE, RIYADH 11383, KINGDOM OF SAUDI ARABIA

www.futurepet.ae | petinfo@enpigroup.com





FUTURE PLAST INDUSTRIES manufactures PET Preforms and HDPE / PP Closures using world class equipment's from HUSKY and SACMI. It has a combined capacity to process 32,000 MT of polymers per annum and has a 16,000 sqm covered ware housing facility to store both Raw Materials and Finished Goods.

The facility is a FSCC 22000 certified with a very well-equipped in-house laboratory for testing incoming Raw Materials and end products complying to all required standards.



FUTURE PLUS is an extension to **FUTURE PLAST** with similar equipment from HUSKY to manufacture PET Preforms and is FSCC 22000 certified. Capacity of the plant is limited to process 7,200 MT with plans to expand to 11,000 MT and as well to equip the facility with Closure production lines. Products are being sold within KSA and as well exported to GCC countries.



ENPI GROUP was established in 1995, as a manufacturer of packaging and plastic materials. Ever since, the company has followed a successful growth strategy that created today's large regional diversified packaging player. All Business Units are among the leaders of their industries.

A continuous expansion into new technologies has made **ENPI GROUP** the regional pioneer in many fields of its activities. Therefore the packaging solutions offered in paper and plastic are world class. Our customers, including the high-end multinational brand owners, appreciate our state of the art technologies, continuous investment in new production facilities and our vast industry experience.

MEMBERS OF EMIRATES NATIONAL FACTORY FOR PLASTIC INDUSTRIES L.L.C.:

PREFORMS & CLOSURES:

FUTURE PLAST | FUTURE PLUS

FLEXIBLE PACKAGING & LABELS:

FLEX PACK | FUTURE PACK | UNITED SECURITY

CUPS, CONTAINERS & CLING FILM:

CUPCO | TAIBAH

FOOD PACKAGING & HYGIENE SOLUTIONS:

CITY PACK

FILMS & BAGS:

FUTURE FILM

www.enpigroup.com

SUSTAINABILITY

FUTURE PLAST / PLUS play an important part in the food and beverage supply chain, whilst at the same time fulfilling our role as valuable members of the communities that we serve.

An example is our contribution to the development of the first transparent bio-degradable PLA (Polylactic Acid) water bottle produced in the Middle East made from 100 percent plant-based polymers.

FUTURE PLAST Industries is one of the first company in the middle east to initiate the light weighting exercise and have introduced 29/25 tooling's in the year 2011, wherein the Neck weight reduction of 1.5 grams was achieve as compare to traditional 30/25 High neck Preform design. Then as part of the company's continuous commitment to sustainability thru down gauging, the company introduced the Flat neck Preform for Tear-lid off Bottles,

wherein a typical package of Preforms for 200 ml water weighing 8.0 to 9.0 grams plus a plastic closure of 1.2 to 1.5 grams (so total of 9.2 to 10.5 grams) is alternatively replaced with 6.38 grams without the need of Plastic enclosure and replaced by aluminum lid instead. This weight reduction not only reduce the carbon foot print because of the reduction of energy used to produce it (lesser weight and therefore with lesser cycle time and hence more output) and the CO2 used in transport (because of lesser weight and geometry, the qty is more per shipment), but since the weight reduction translates into using fewer resources, and therefore being more sustainable.

Above developments has been carried out together with HUSKY & BOSCH. We are in discussions with KHS - Germany and SMI - Italy for supporting us with higher output rotary combi lines to provide sustainable solutions to our potential customers with flat neck preforms.





QUALITY & ENVIRONMENT

The entire facility is FSSC 22000 version 4.1 certified and has a very well-equipped in-house laboratory to ensure all products are manufactured to meet industry standards (a scheme that is recognized by the Global Food Safety Initiative (GFSI)). This recognition demonstrates highest standards globally, leading to international food industry acceptance. Its in-house quality control department conducts tests as per the technical parameters outlined by BS and ASTM standards.

Equipment is in place to check the incoming raw materials, as well the finished products. Random sampling / testing is done for every batch manufactured and recorded in order for a certificate of compliance to be issued with each shipment.

FUTURE PLAST / PLUS is committed to environmentally friendly practices in both the manufacturing process and the waste disposal of substrates. Annually Future Plast in going under stringent environmental emissions, indoor air quality and noise monitoring/testing process to ensure its compliance against UAE Federal law no. (24) of 1999 – Protection and development of the environment, Applicable Decrees and OSHAD Code of practice 3.0 - Occupational Noise.

FUTURE PLAST / PLUS closely monitors its adherence to environmental standards, taking into account energy efficiency, waste disposal and working conditions.

CUSTOMER FOCUS

Since the products are exported worldwide to more than 20 countries, **FUTURE PLAST / PLUS** employs highly qualified multilingual professionals to ensure efficient production translates into cost effective high quality products and unparalleled customer care. We provide technical assistance to its customers such as process intervention, trouble shooting, blowing process optimization, new product development, light weighting, proto typing and customization.

All decisions and changes within **FUTURE PLAST / PLUS** are made with the customer in mind. Constant interactivity with customers means our multi-lingual and experienced team knows what our customers need and when they need it, and are trained to give excellent customer service at all stages of the client relationship. They act as the primary point of contact between the client and the internal teams who are involved with designing and manufacturing the products on order.



PET PREFORMS WITH 30/25 HIGH NECK FINISH FOR MINERAL WATER

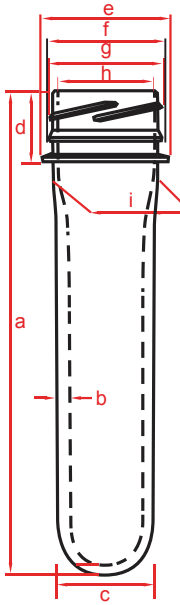

PREFORM WEIGHT	9.0g	11.34g	11.70g	13.0g	14.0g	15.15g	16.0g	17.0g	18.5g	21.0g	23.0g	27.9g	28.5g	29.4g	30.0g	31.9g	32.5g	38.0g	40.0g
Neck finish	30/25 high neck finish																		
Ref no.	PN006453	6577039	5973296	5009958	5827020	5974250	5378817	4546691	6552363	4609988	7317116	PN006887	6994222	PN006639	6084120	PN006886	4540095	6552645	6552492
Weight (gms)	9.0 ± 0.20	11.34 ± 0.20	11.70 +/- 0.20	13.00 +/- 0.20	14.00 +/- 0.40	15.15 +/- 0.20	16.00 +/- 0.20	17.00 +/- 0.20	18.50 +/- 0.20	21.00 +/- 0.30	23.00 +/- 0.30	27.9±0.30	28.5±0.30	29.4.00 +/- 0.30	30.00 +/- 0.30	31.90 +/- 0.30	32.50 +/- 0.30	38.0 +/- 0.40	40.0 +/- 0.40
Total length (mm)	a 62.9 ± 0.50	75.3 ± 0.50	74.00 +/- 0.50	74.00 +/- 0.50	83.05 +/- 0.50	90.00 +/- 0.50	83.05 +/- 0.50	90.00 +/- 0.50	90.00 +/- 0.50	99.50 +/- 0.50	99.50 +/- 0.50	120.0 ± 0.50	120.0 ± 0.50	120.00 +/- 0.50	120.00 +/- 0.50	120.00 +/- 0.50	120.00 +/- 0.50	142.50 +/- 0.71	142.50 +/- 0.71
Wall thickness (mm)	b 1.98 ± 0.19	2.25 ± 0.19	2.09 +/- 0.19	2.60 +/- 0.19	2.10 +/- 0.19	2.11 +/- 0.15	2.70 +/- 0.19	2.60 +/- 0.15	3.03 +/- 0.15	2.58 +/- 0.15	2.98 +/- 0.15	2.63 ± 0.15	2.63 ± 0.15	2.83 +/- 0.15	2.83 +/- 0.15	3.17 +/- 0.15	3.17 +/- 0.15	2.89 +/- 0.15	3.10 +/- 0.15
Body outer dia (mm)	c 16.20 ± 0.25	16.44 ± 0.25	17.70 +/- 0.25	17.70 +/- 0.25	19.77 +/- 0.25	19.60 +/- 0.25	19.77 +/- 0.25	19.60 +/- 0.15	19.60 +/- 0.15	22.80 +/- 0.27	22.80 +/- 0.27	25.50 ± 0.27	25.50 ± 0.27	25.50 +/- 0.27	25.50 +/- 0.27	25.50 +/- 0.27	25.50 +/- 0.27	26.67 +/- 0.27	26.67 +/- 0.27
Neck height (mm)	d								18.50 +/- 0.15										
NSR dia (mm)	e								34.00 +/- 0.15										
PPD dia (mm)	f								30.20 +/- 0.15										
Thread dia (mm)	g								30.00 +/- 0.15										
Bore dia (mm)	h								25.10 +/- 0.10										
Below NSR dia (mm)	i								28.00 +/- 0.15										
Preforms per Gaylord	24,480	21,600	21,792	21,792	17,760	16,800	17,760	16,800	16,800	13,440	13,440	9,408	9,408	9,408	9,408	9,408	9,408	7,296	7,296
Gaylords per 40'HC FCL	44																		
Qty /40'HC FCL	1,077,120	950,400	979,968	979,968	781,440	739,200	781,440	739,200	739,200	591,360	591,360	413,952	413,952	413,952	413,952	413,952	413,952	321,024	321,024
Preforms per carton (PCS)	2,208	2,016	2,016	2,016	1,632	1,536	1,632	1,536	1,536	1,248	1,248	864	864	864	864	864	864	672	672
Cartons per 40' HC FCL	580 - 590																		
Qty /40'HC FCL	1,280,640	1,169,280	1,169,280	1,169,280	946,560	890,880	946,560	890,880	890,880	723,840	723,840	501,120	501,120	501,120	501,120	501,120	501,120	389,760	389,760

PET PREFORMS WITH 28 MM PCO 1810 NECK FINISH FOR CSD / MINERAL WATER

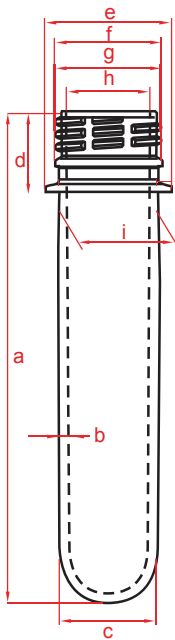

PREFORM WEIGHT		17.4g	19.0g	23.0g	24.0g	27.0g	32.0g	35.0g	38.0g	44.0g	51.6g	53.0g
Neck finish		1810 neck finish										
Ref no.		6082776	5000344	5000165	6993748	5000422	5771844	5314065	5765532	5776344	6390135	6390244
Weight (gms)		17.40 +/- 0.20	19.00 +/- 0.20	23.00 +/- 0.30	24.00 ± 0.30	27.00 +/- 0.30	32.00 +/- 0.30	35.00 +/- 0.40	38.00 +/- 0.40	44.00 +/- 0.40	51.60 +/- 0.52	53.00 +/- 0.53
Total Length (mm)	a	95.00 +/- 0.50	95.00 +/- 0.50	95.00 +/- 0.50	95.00 ± 0.50	102.00 +/- 0.50	124.00 +/- 0.62	124.00 +/- 0.62	124.00 +/- 0.62	145.00 +/- 0.72	153.80 +/- 0.77	153.80 +/- 0.77
Wall thickness (mm)	b	2.07 +/- 0.15	2.48 +/- 0.15	3.57 +/- 0.20	3.90 ± 0.20	3.53 +/- 0.15	2.85 +/- 0.15	3.25 +/- 0.15	3.67 +/- 0.15	3.34 +/- 0.15	3.67 +/- 0.15	3.81 +/- 0.15
Body outer dia (mm)	c	20.50 +/- 0.15	20.50 +/- 0.15	20.50 +/- 0.15	20.50 ± 0.15	22.80 +/- 0.15	25.50 +/- 0.15	25.50 +/- 0.15	25.50 +/- 0.15	26.67 +/- 0.15	27.91 +/- 0.15	27.91 +/- 0.15
Neck height (mm)	d					21.00 +/- 0.25						
NSR dia (mm)	e					33.00 +/- 0.20						
PPD dia (mm)	f					27.97 +/- 0.13						
Thread dia (mm)	g					27.43 +/- 0.13						
Bore dia (mm)	h					21.74 +/- 0.13						
Below NSR dia (mm)	i			25.7 +/- 0.15				25.50 +/- 0.15				
Preforms per Gaylord		15,744	15,744	15,744	15,744	13,440	9,696	9,696	9,696	7,488	6,624	6,624
Gaylords per 40'HC FCL		44										
Qty /40'HC FCL		692,736	692,736	692,736	692,736	591,360	426,624	426,624	426,624	329,472	291,456	291,456
Preforms per carton (PCS)		1,440	1,440	1,440	1,440	1,248	864	864	864	672	576	576
Cartons per 40' HC FCL		580 - 590										
Qty /40'HC FCL		835,200	835,200	835,200	835,200	723,840	501,120	501,120	501,120	389,760	334,080	334,080

PET PREFORMS WITH 29/25 SHORT NECK FINISH FOR MINERAL WATER

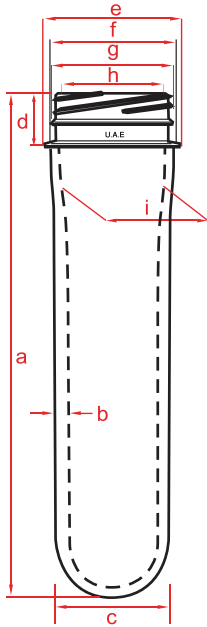

PREFORM WEIGHT	8.1g	9.3g	9.3g	10.4g	12.5g	13.5g	19.5g	21.0g	27.0g	28.5g
Neck finish	29/25 neck finish									
Ref no.	7363669	7363777	6340128	6340054	5424494	5362241	6398391	PN006703	6992383	5367180
Weight (gms)	8.10 +/- 0.20	9.30 +/- 0.20	9.30 +/- 0.20	10.40 +/- 0.20	12.50 +/- 0.20	13.50 +/- 0.20	19.50 +/- 0.20	21.0 +/- 0.30	27.0 ± 0.30	28.50 +/- 0.30
Total Length (mm)	a 57.00 +/- 0.50	57.00 +/- 0.50	68.00 +/- 0.50	68.00 +/- 0.50	77.15 +/- 0.50	77.15 +/- 0.50	93.6 +/- 0.50	91.00 +/- 0.50	114.10 ± 0.50	114.10 +/- 0.50
Wall thickness (mm)	b 1.96 +/- 0.19	2.67 +/- 0.19	2.00 +/- 0.19	2.46 +/- 0.19	2.10 +/- 0.19	2.40 +/- 0.19	2.59 +/- 0.19	3.37 +/- 0.20	2.63 +/- 0.19	2.83 +/- 0.19
Body outer dia (mm)	c 16.20 +/- 0.25	16.20 +/- 0.25	16.74 +/- 0.25	16.74 +/- 0.25	19.77 +/- 0.25	19.77 +/- 0.25	22.80 +/- 0.20	20.50 +/- 0.15	25.50 ± 0.25	25.50 +/- 0.20
Neck height (mm)	d	12.60 +/- 0.10								
NSR dia (mm)	e	32.50 +/- 0.20								
PPD dia (mm)	f	30.50 +/- 0.10								
Thread dia (mm)	g	29.40 +/- 0.13								
Bore dia (mm)	h	25.10 +/- 0.13								
Below NSR dia (mm)	i	28.00 +/- 0.15	28.00 +/- 0.15	27.50 +/- 0.20			28.00 +/- 0.15			
Preforms per Gaylord	32,640	32,640	27,264	27,264	20,736	20,736	15,072	16,512	10,464	10,464
Gaylords per 40' HC FCL	44									
Qty /40'HC FCL	1,436,160	1,436,160	1,199,616	1,199,616	912,384	912,384	663,168	726,528	460,416	460,416
Preforms per carton (PCS)	2,976	2,976	2,592	2,592	1,920	1,920	1,344	1,536	960	960
Cartons per 40' HC FCL	580 - 590									
Qty /40'HC FCL	1,726,080	1,726,080	1,503,360	1,503,360	1,113,600	1,113,600	779,520	890,880	556,800	556,800

PET PREFORMS WITH 28 MM PCO 1881 NECK FINISH FOR CSD/MINERAL WATER

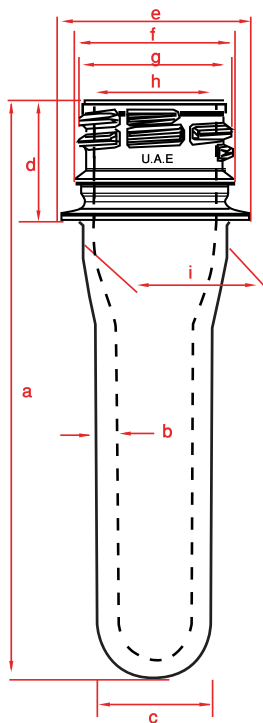

PREFORM WEIGHT	16.75g	17.68g	22.2g	25.5g	36.46g	50.06g
Neck finish	1881 neck finish					
Ref no.	6387993	6387938	6387710	7026734	6387828	6388465
Weight (gms)	16.75 +/- 0.20	17.68 +/- 0.20	22.20 +/- 0.30	25.50 +/- 0.30	36.46 +/- 0.40	50.06 +/- 0.50
Total Length (mm)	a 91.00 +/- 0.50	91.00 +/- 0.50	91.00 +/- 0.50	98.00 +/- 0.50	120.00 +/- 0.50	149.80 +/- 0.75
Wall thickness (mm)	b 2.24 +/- 0.15	2.47 +/- 0.15	3.71 +/- 0.20	3.49 +/- 0.20	3.63 +/- 0.15	3.64 +/- 0.15
Body outer dia (mm)	c 20.50 +/- 0.15	20.50 +/- 0.15	20.50 +/- 0.15	22.80 +/- 0.15	25.50 +/- 0.15	27.91 +/- 0.15
Neck height (mm)	d	17.00 +/- 0.25				
NSR dia (mm)	e	33.00 +/- 0.20				
PPD dia (mm)	f	27.97 +/- 0.13				
Thread dia (mm)	g	27.43 +/- 0.13				
Bore dia (mm)	h	21.74 +/- 0.13				
Below NSR dia (mm)	i	25.70 +/- 0.15			25.50 +/- 0.15	
Preforms per Gaylord	16,512	16,512	16,512	13,440	9,696	6,912
Gaylords per 40' HC FCL	44					
Qty /40'HC FCL	726,528	726,528	726,528	591,360	426,624	304,128
Preforms per carton (PCS)	1,536	1,536	1,536	1,248	864	576
Cartons per 40' HC FCL	580 - 590					
Qty /40'HC FCL	890,880	890,880	890,880	723,840	501,120	334,080





CLOSURE 30/25 HIGH NECK FINISH 29/25 SHORT NECK FINISH 28MM PCO-1810 AND 1881 NECK FINISH 2 PIECE WITH LINER 28MM PCO-1881 NECK FINISH 1 PIECE HDPE

CLOSURE TYPE	30/25 HIGH NECK	30/25 BTL HIGH NECK	29/25 NECK FINISH	28 mm PCO 1881-1 PC CSD	"28 mm PCO1881 -1 PC STILL WATER & JUICES"	28 mm PCO 1810-2 PIECE
Ref no.	UCM00198633	UCM001A8294	UCM001A8067	UCM001A8231	UCM001A8233	UCM00198293
Material	HDPE					
Weight (gms)	1.75 +/- 0.05	1.80±0.05	1.17 +/- 0.05	2.15 +/- 0.05	1.95 +/- 0.05	3.17 +/- 0.05
Total height (mm)	16.3 +/- 0.3	16.75 ± 0.30	11.35 +/- 0.3	15.60 +/- 0.3	15.60 +/- 0.3	20.00 +/- 0.3
Number of knurls	90	90	72	120 & 24/120	120 & 24/120	120
Body outer dia (mm)	32.60 +/- 0.30	32.60 ± 0.30	31.20 +/- 0.30	31.05 ± 0.30	31.05 ± 0.30	32.00 +/- 0.30
Engraving	Yes	Yes	Yes	N/A	N/A	N/A
Printing	N/A	N/A	N/A	Yes	Yes	Yes
Caps per carton	6,000	6,000	8,500	7,488.00	5,300.00	7,488.00
Cartons / 40'HC FCL	600	600	600	600	864	600
Qty /40'HC FCL	3,600,000	3,600,000	5,100,000	4,492,800	4,579,200	4,492,800

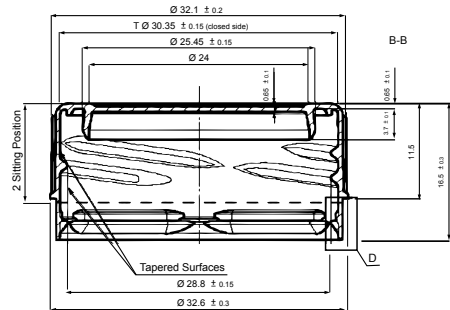

30/25 HIGH NECK

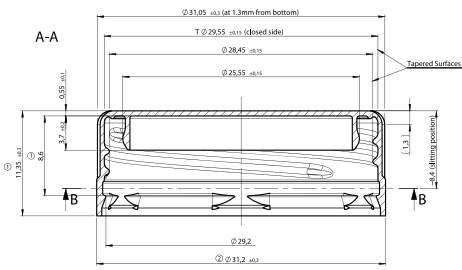

29/25 SHORT NECK

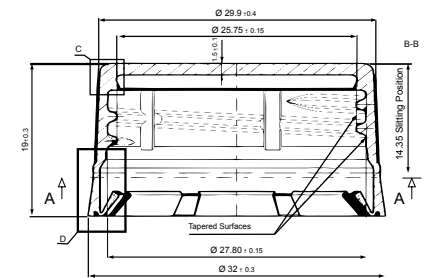

28 MM 1810 PCO (2 PIECE)

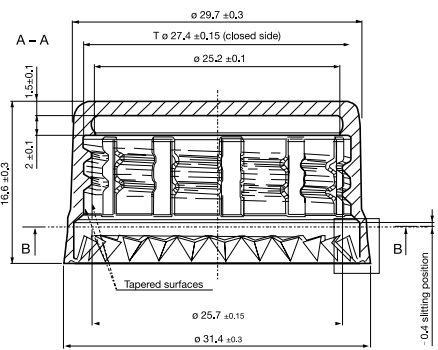

28 MM 1881 PCO (2 PIECE)

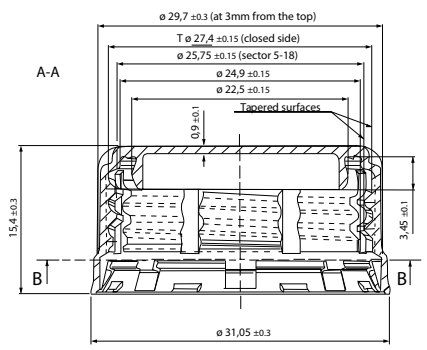

28 MM 1881 (PCO) 1 PIECE CSD

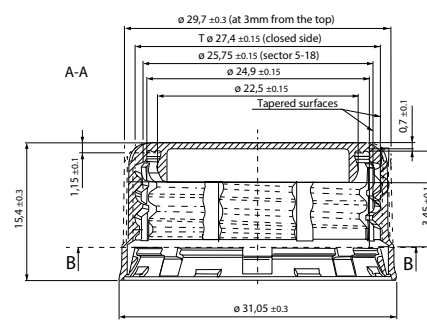

28 MM 1881 (1 PIECE)

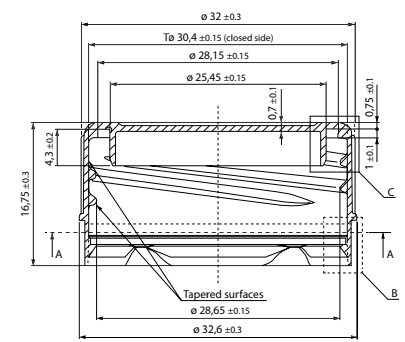

30/25 MM BTL HIGH NECK